

Data Sheet: Ellis Patents EMPEROR Single Cable Cleat with LSF Liner

Emperor cable cleats are recommended for installations where the highest levels of short circuit withstand are required. In addition to single applications, Emperor cable cleats are available for dual, trefoil, triplex (using optional 'SFT' cable surround), quad and bundled cable applications. Emperor cable cleats are independently certified to BS EN 50368:2003, Category-2 resistance to electromechanical forces during short circuits (i.e. cable and cleats are intact and reusable after two successive short circuit tests). To protect and cushion cables, Emperor cleats incorporate an integral low smoke, low fume, zero halogen liner in its unique patented design. Recommended fixing methods include one bolt, two bolts, weld stud or framing strut mounting. Optional rung adapters are available to mount Emperor cable cleats to non-perforated ladder tray rungs.

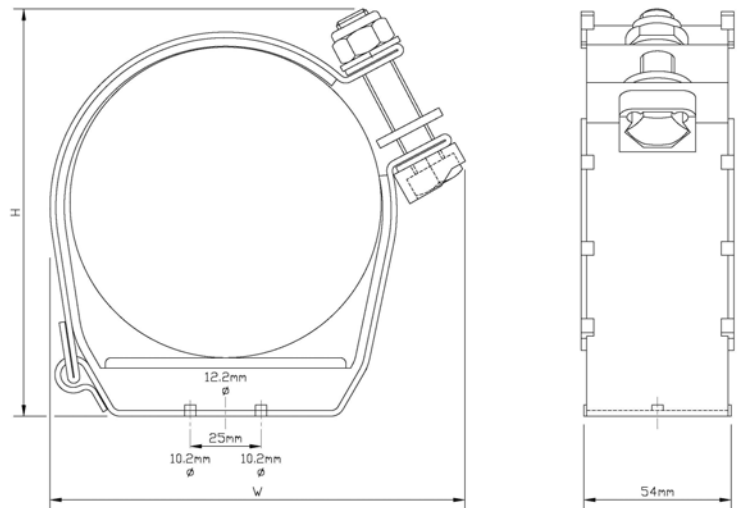

Part No ES'X' 'X' = Nominal Cable Diameter	Dimensions (mm)		Weight (kg)
	H	W	
ES34, ES35, ES36, ES37	84	87	0.400
ES38, ES39, ES40, ES41	89	91	0.400
ES42, ES43, ES44	90	92	0.400
ES45, ES46, ES47, ES48	93	96	0.420
ES49, ES50, ES51	94	97	0.420
ES52, ES53, ES54, ES55	98	99	0.430
ES56, ES57, ES58	99	100	0.430
ES59, ES60, ES61, ES62	102	103	0.450
ES63, ES64, ES65	103	104	0.450
ES66, ES67, ES68, ES69	101	109	0.460
ES70, ES71, ES72	102	110	0.460
ES73 to ES130	Consult kVA Strategies		

BS EN 50368:2003 (Cable Cleats for Electric Installations) Classification	
Cleat Type	Composite
Operating Temperature Range	-40°C to + 60°C
Resistance to Electromechanical Force (Refer to kVA Strategies for Details)	Category-1: 235kA _{PEAK} / 109kA _{RMS} Category-2: 178kA _{PEAK} / 83kA _{RMS}
Lateral Load Test	Refer to kVA Strategies
Axial Load Test	650N
Impact Resistance	Very Heavy (>6.7kg @ 300mm)
Needle Flame Test	>120 seconds

Technical Specifications	
Frame	50mm W x 2mm Thick Marine Grade, Non-magnetic 316L Stainless Steel (BS EN 10088)
Closure Hardware	316L Stainless Steel M12 Bolt, Nyloc Nut & Flat Washer (BS 3692)
Integral LSF Liner	Low Smoke, Low Fume Zero Halogen Polymer
Tools Required	3/4" or 19mm
Installation Features	Captive Closure Bolt 1 or 2 Bolt Mounting (3/8" Max Dia)